



Dallas Love Field Community Weekly Update

IN THIS ISSUE

Crazy little thing called Love... Field

By: Lanre Olaniyan

Announcements

Dalfort Aerospace formerly known as the Braniff building may be in for a change! New concept art of the historic building can be seen above. All dependant on City Council vote and approval by the State Historic Preservation Commission.

Interesting fact! 1.27 million people got on and off airline flights at DAL airport last month, up 63.8% from the 775,308 who used DAL in July 2014. #DallasLoveField!

You can follow Dallas Love Field on Facebook at: www.facebook.com/DallasLoveField

Noise Complaints

You may still submit noise complaints to the Department of Aviation through the PublicVue portal on the Love Field website at www.dallas-lovefield.com and clicking the "Aircraft Noise Complaints" button on the right side of the screen. You may also submit complaints via the Airport Communications Center at 214-670-LOVE (5683). The Airport Communications Center (ACC) is staffed 24 hours a day to direct your airport related concerns.



Construction Updates

Page 2

Runway Closures

Page 2

Airport Diagram

Page 3

Airport Operations Report

Pages 4-5

Upcoming LFEAC Meetings...

Thursday October 8, 2015

Thursday January 14, 2016

Thursday April 14, 2016

Construction Updates



Runway Closures

Scheduled Runway and Taxiway Closures

All closures will be coordinated through Airport Operations and will be permitted based on weather and operational impact.

- Sun/Aug 23rd at 2330 – Mon/Aug 24th at 0500: Runway 13R/31L closed for Airfield Maintenance painting shoulder markings and conducting pavement repairs.
- Mon/Aug 24th at 2330 – Tue/Aug 25th at 0500: Taxiway C closed between Jet Aviation south ramp entrance and Taxiway C1 for Airfield Maintenance painting taxiway centerline, edge lines and enhanced centerline. The south entrance of Jet Aviation will remain open.
- Tue/Aug 25th at 2330 – Wed/ Aug 26th at 0500: Taxiway C closed between Taxiways C1 and C3 for Airfield Maintenance painting centerline, edge lines and shoulder markings. Taxiways C1 and C3 will remain open.
- Wed/Aug 26th at 2330 – Thur/ Aug 27th at 0500: Runway 13L/31R closed for Airfield Maintenance painting runway centerline markings and taxiway leadoff lines.

Ongoing Airfield Closures

The following taxiways will remain closed until further notice:

- Taxiway D closed between Taxiway C and D1.
- Taxiway D1, closed as needed from 0700-1700 for work on the shoulder. Taxiway D will be available at Taxiway D1 intersection.
- Taxiway B closed between Taxiway B1 and Taxiway S for MCM pavement work.
- Taxilane P closed for RON C/Taxilane P realignment
- Taxiway D between Taxiway B & Taxilane Q, Taxiway B5 between Taxiways B & D and Taxiways D3 & P will be closed for 17 days for MCM installing taxiway lighting and other work associated with the relocation of Taxiway P.

*** Please see the airport diagram on the next page for locations of runways and taxiways.**

15064

AIRPORT DIAGRAM

AL-106 (FAA)

DALLAS-LOVE FIELD (DAL)
DALLAS, TEXAS

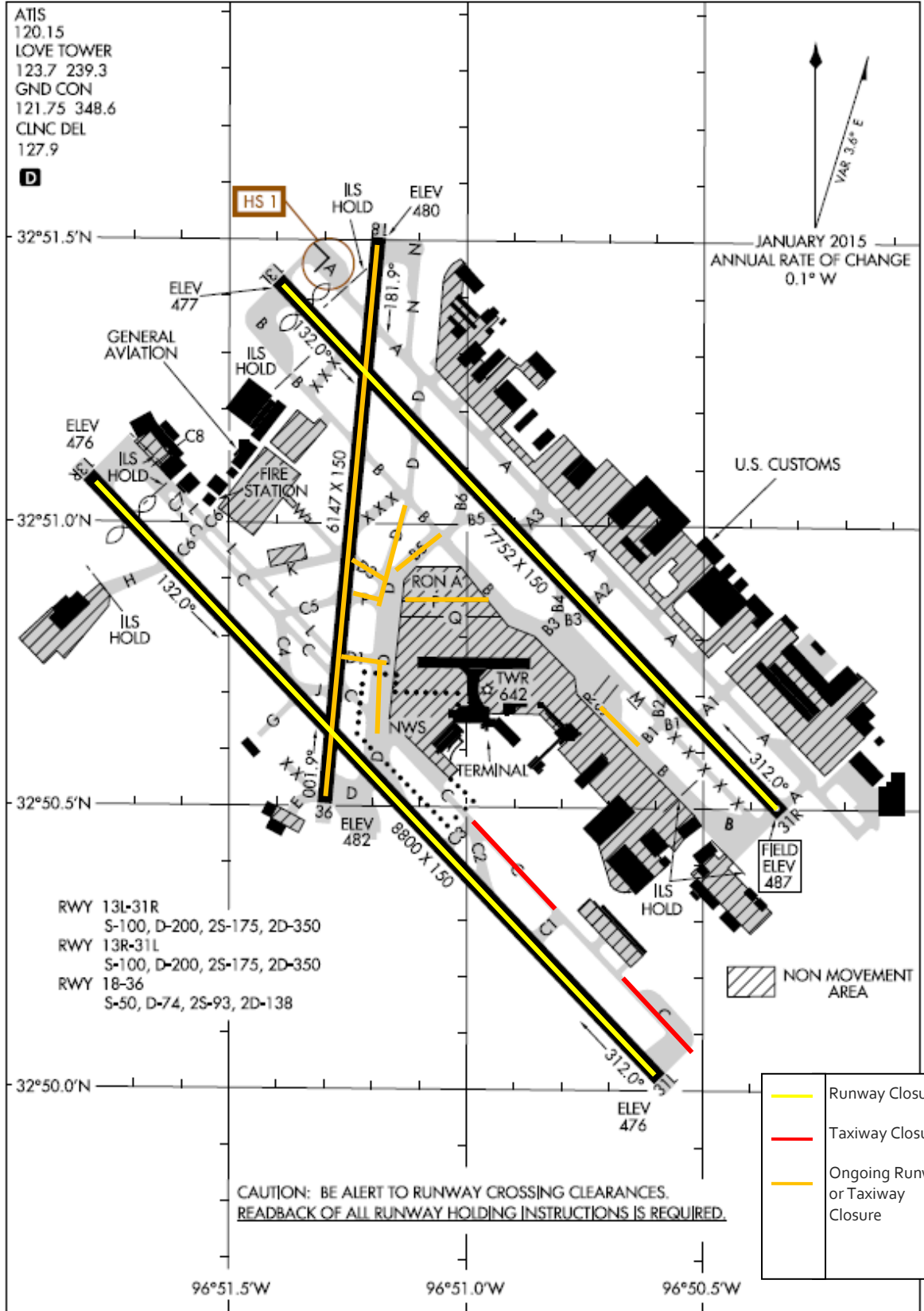

AIRPORT DIAGRAM

15064

DALLAS, TEXAS
DALLAS-LOVE FIELD (DAL)

SC-2, 28 MAY 2015 to 25 JUN 2015

SC-2, 28 MAY 2015 to 25 JUN 2015

Airport Operations Report

All Operations for the Week of August 9 - August 15, 2015

	Runway 13L/31R (Lemmon)				Runway 13R/31L (Denton)			
	13L	31R	Total	Avg/Day	13R	31L	Total	Avg/Day
ARRIVALS	804	269	1073	153	580	377	957	137
COMMERCIAL	473	101	574	82	442	323	765	109
GENERAL AVIATION	218	114	332	47	104	36	140	20
OTHER	113	54	167	24	33	17	50	7
DEPARTURES	507	412	919	131	895	266	1161	166
COMMERCIAL	172	225	397	57	736	209	945	135
GENERAL AVIATION	208	130	338	48	107	41	148	21
OTHER	127	57	184	26	51	15	66	9

	Combined Operations	
TOTAL ARRIVALS	2030	290
TOTAL DEPARTURES	2080	297
TOTAL OPERATIONS	4110	587

*Total arrival and departure counts include operations that are listed as "unknown" in the system due to radar coverage that doesn't correlate them with a runway in the Noise and Operations Monitoring System.

**Aircraft classified as other include military operations, non-scheduled commercial operations such as charter flights/air taxi, and helicopter operations.

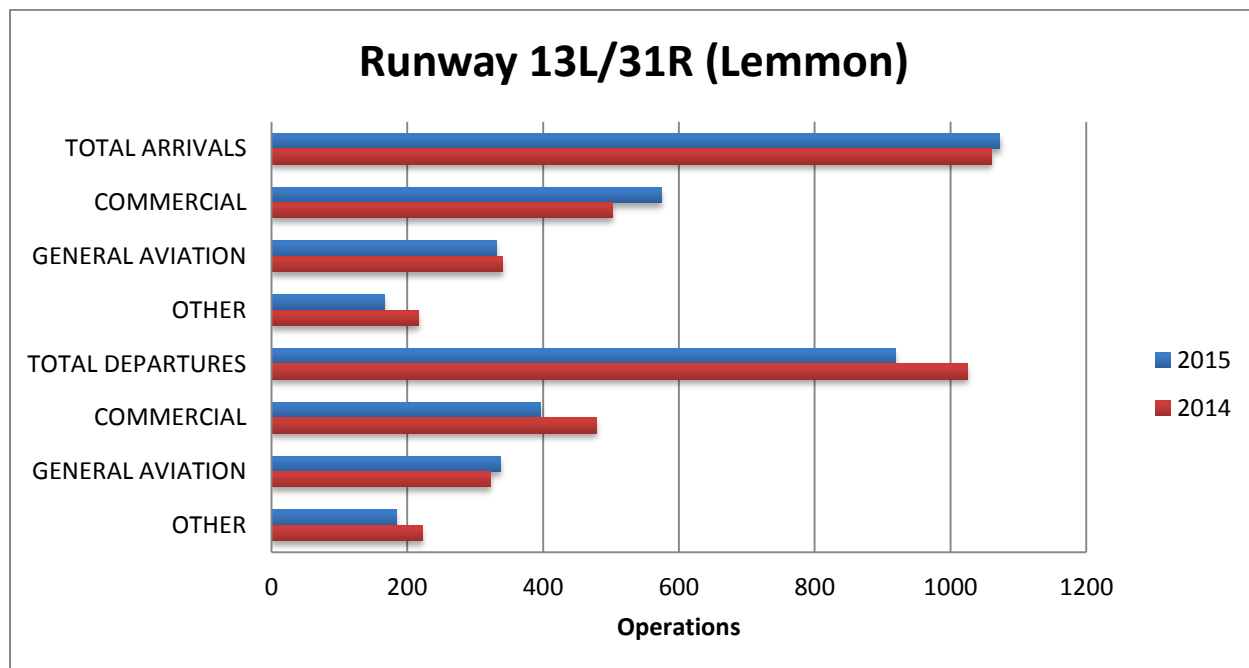

- Tue/Aug 12, 2014: Runway 13L/31R was closed.
- Wed/Aug 12, 2015 at 2330 – Thur/Aug 13, 2015 at 0500: Runway 13L/31R closed

Airport Operations Report Continued

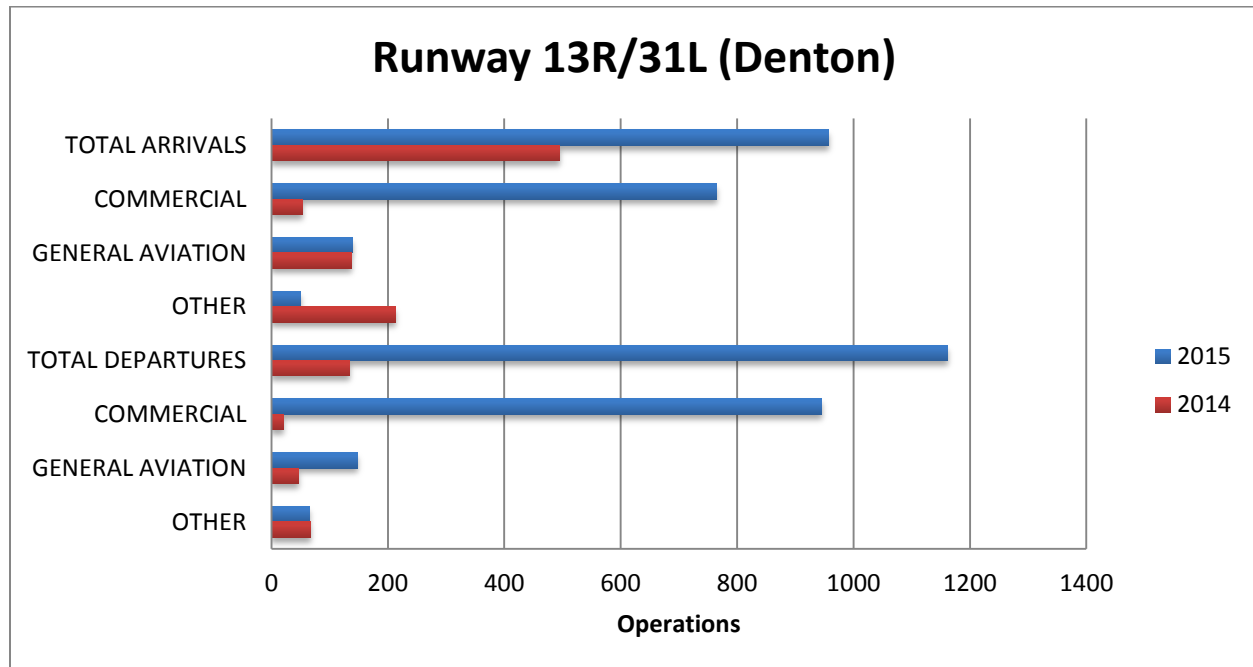

- Sun/Aug 9, 2015 at 2330 – Mon/Aug 10, 2015 at 0500: Runway 13R/31L was closed.

Dallas Love Field

8008 Herb Kelleher Way LB 16

Dallas, Texas 75235

For questions or concerns please contact:

Lanre Olaniyan

Interim Airport Noise Coordinator

214-670-6673

Olanrewaju.Olaniyan@dallascityhall.com



EMAIL 214670LOVE@DALLASCITYHALL.COM
PHONE 214-670-LOVE (5683)

In an effort to serve you better, Dallas Love Field has opened the Airport Communications Center (ACC) for your use. The ACC is staffed 24 hours a day to direct your airport related concerns. If you are submitting an aircraft noise complaint please call the ACC at 214-670-LOVE (5683). Complaints may also be submitted through the airport's aircraft noise and operations portal, PublicVue. To submit complaints through the PublicVue module, please visit www.dallas-lovefield.com and click on "Aircraft Noise Complaints".